

Ceiling Mounting

Placement is important to any acoustic treatment and should be determined before any installation occurs. Generally, you should mount panels across the diagonal of corners for broadband absorption, and at reflection points to the listening position for early reflection control. When mounting in critical listening environments [studio control rooms, mixing suites, and home theaters], strive to maintain left to right symmetry with all your panel placements – this will sharpen the stereo image. If you have any doubt as to where your panels should be mounted, please visit our web site at readyacoustics.com for placement advice, or use this link:

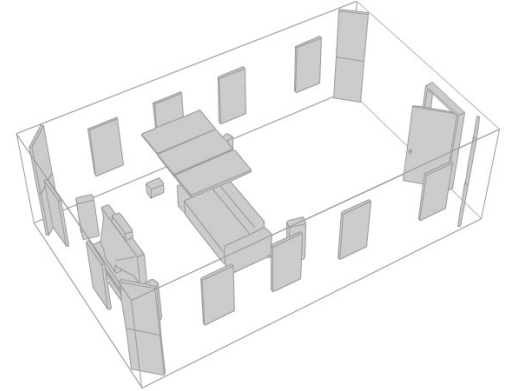

<http://readyacoustics.com/index.php?go=home.what-do-i-need>

Ceiling Mounting Upholstered Panels / Ready Bags:

(see below for how to mount steel framed Chameleon panels)

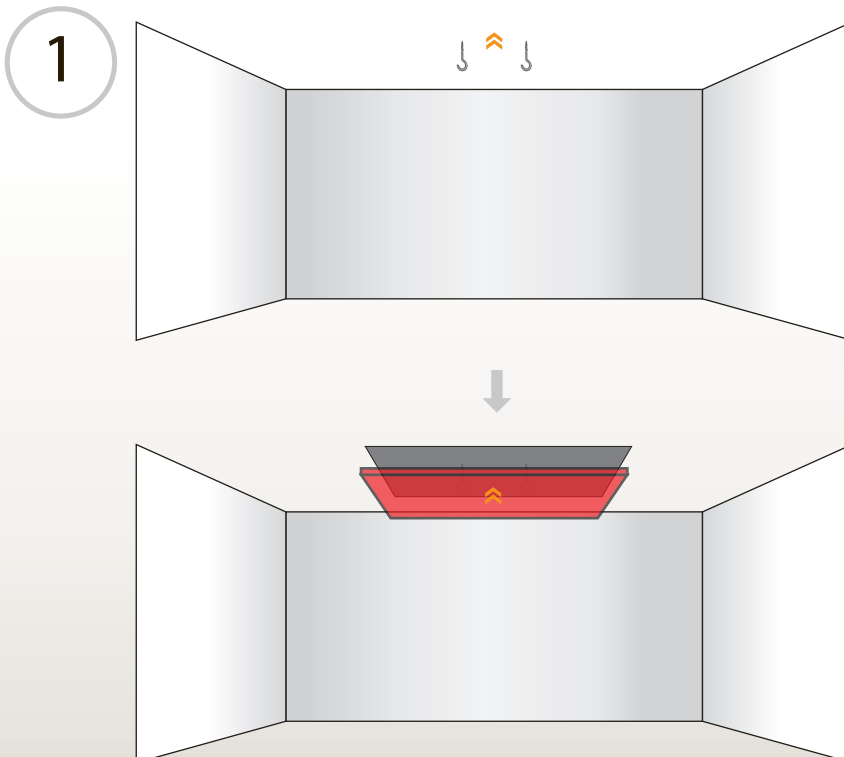

Standard practice for ceiling mounting an upholstered Ready Trap is to simply install two hooks 38" apart on the ceiling and then snap the straps at the ends of the panel over the hooks. You can also use decorative chain or wire to cause the panel to hang lower.



ceiling mounting

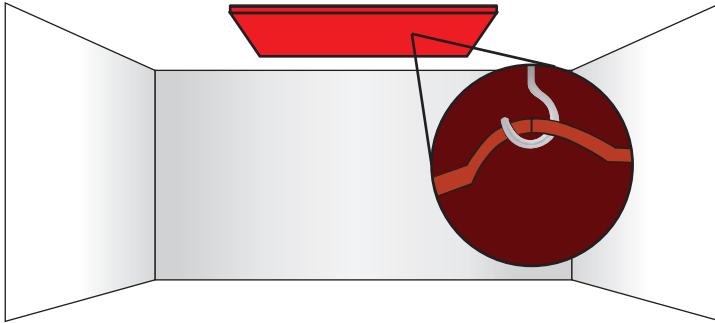

There are integral straps in the back side of an upholstered Ready Trap which can be used to attach decorative chain with “S” hooks, or any number of other types of hanging hardware for situations that may require some creativity to achieve a satisfactory mount. Or, for a suspended “free hang” mounting such as over a knee wall, or from a sloped ceiling, decorative chain and “S” hooks, or cable can be attached to the straps so that Ready Traps can be hung perpendicular to the ceiling in a back-to-back arrangement with a finished look on both sides.



ceiling Mounting

Ceiling Mounting Steel Framed Chameleon Panels:

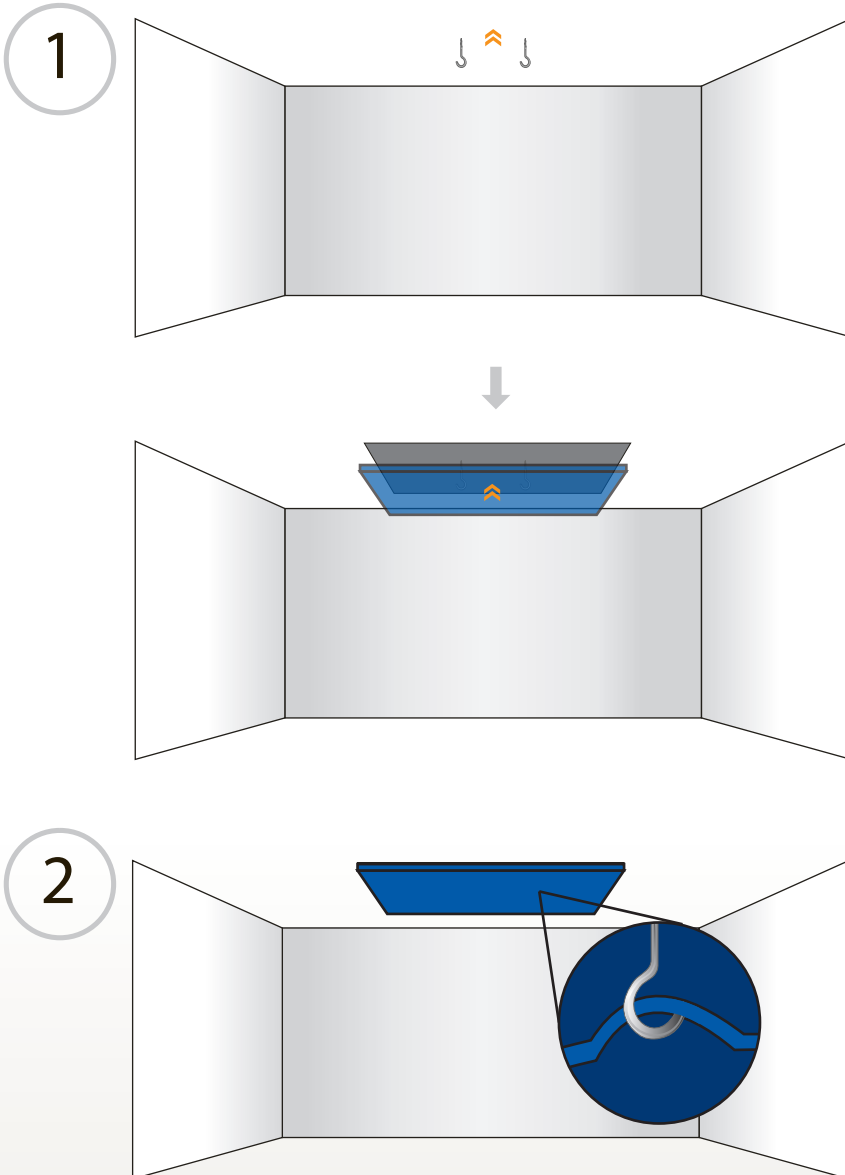

Standard practice for ceiling mounting a steel framed Ready Trap is to simply install two hooks 38" apart on the ceiling and then add two hanger wires, chains or cables to each pair of keyholes on the backside of the steel frame to these hooks. By adjusting the length of the decorative chain or wire you use as a hanger, you can adjust height.

DO NOT USE THE STRAPS ON THE BACKSIDE OF A CHAMELEON PANEL FOR HANGING – INSTEAD USE THE KEYHOLES IN THE STEEL FRAME.

There are keyholes in the back side of the Chameleon frame which can be used to attach picture hanging wire, decorative chain with "S" hooks, or any number of other types of hanging hardware for situations that may require some creativity to achieve a satisfactory mount. Or, for a suspended "free hang" mounting such as over a knee wall, or from a sloped ceiling, decorative chain and "S" hooks, or cable can be attached to the round holes in the top side of the frame so that Chameleons can be hung perpendicular to the ceiling with a finished look on both sides.